

verona stave



Silver THU 9005



White THU

metallic ceilings staves

134

Ceiling Solutions

THU

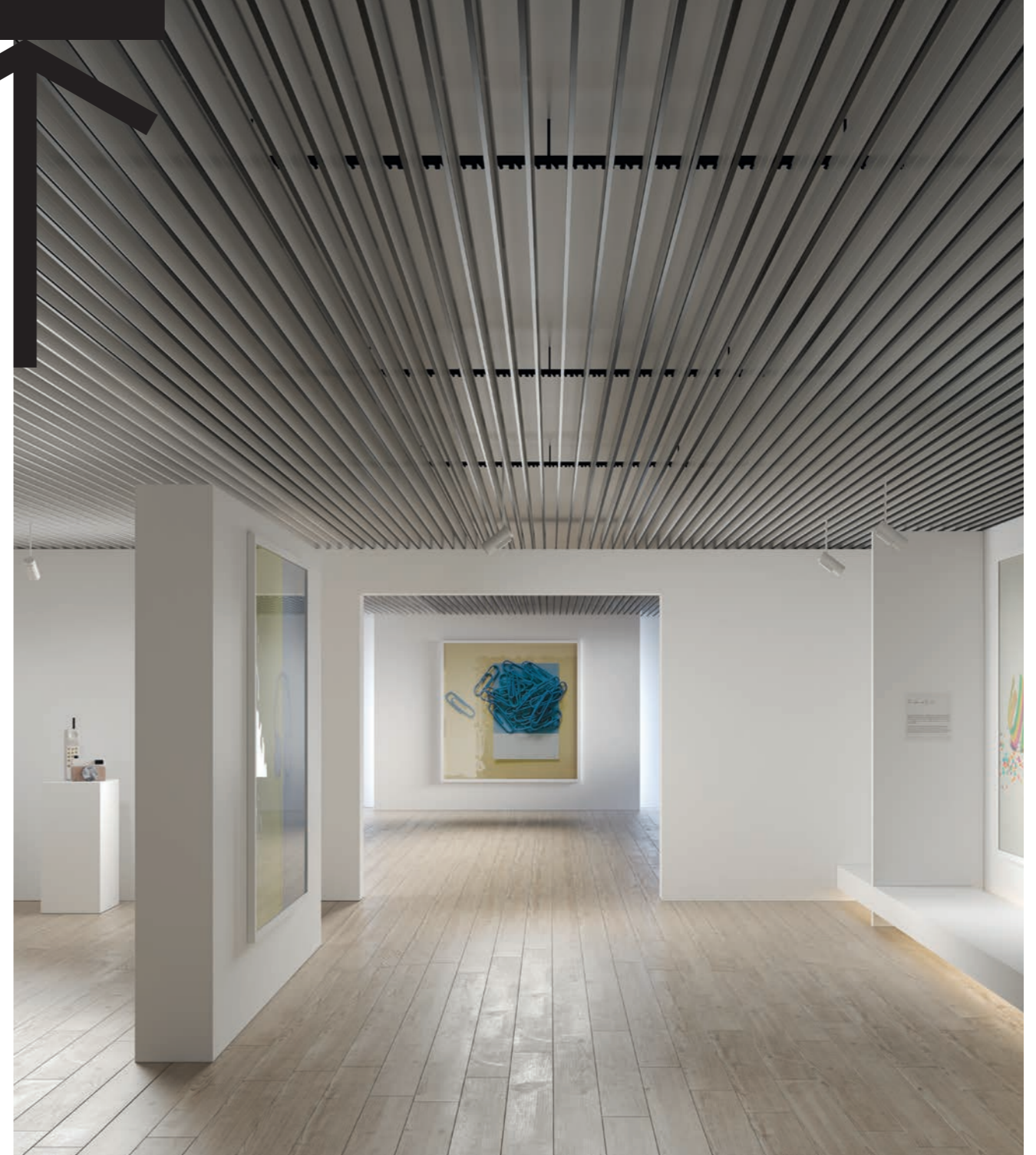

This type of ceiling, comprising vertical staves, allows interplay with light in diaphanous, open spaces. Using a system of black lacquered battens, a structure of vertical staves 100, 150 or 200 mm in height is devised. These are separated according to the size of the stave, thus allowing a plethora of different combinations.

The staves are manufactured in highly resistant and durable aluminium and since this forms an open drop ceiling, it is easy to maintain and the plenum space can be accessed easily.

formats

MODEL	PLATE		BOX
	mm	m ²	units
Vertical	100	-	20
	150	-	20
	200	-	20

finishes

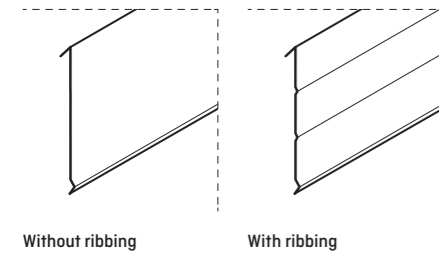

standard colours

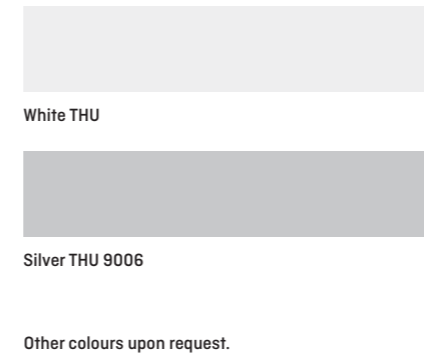

Ceiling Solutions

THU

technical characteristics

Reaction to fire	Durability	% Recycled Material
A1	Class B	18%

performance features

MODEL	TYPE	Units by m ²
Verona 100	Stave	10 ml <small>(100 mm gap between staves)</small>
	Batten	1 ml
Verona 150	Stave	6.67 ml <small>(150 mm gap between staves)</small>
	Hanger part	1 units
Verona 200	Stave	5 ml <small>(200 mm gap between staves)</small>
	Hanger part	1 units

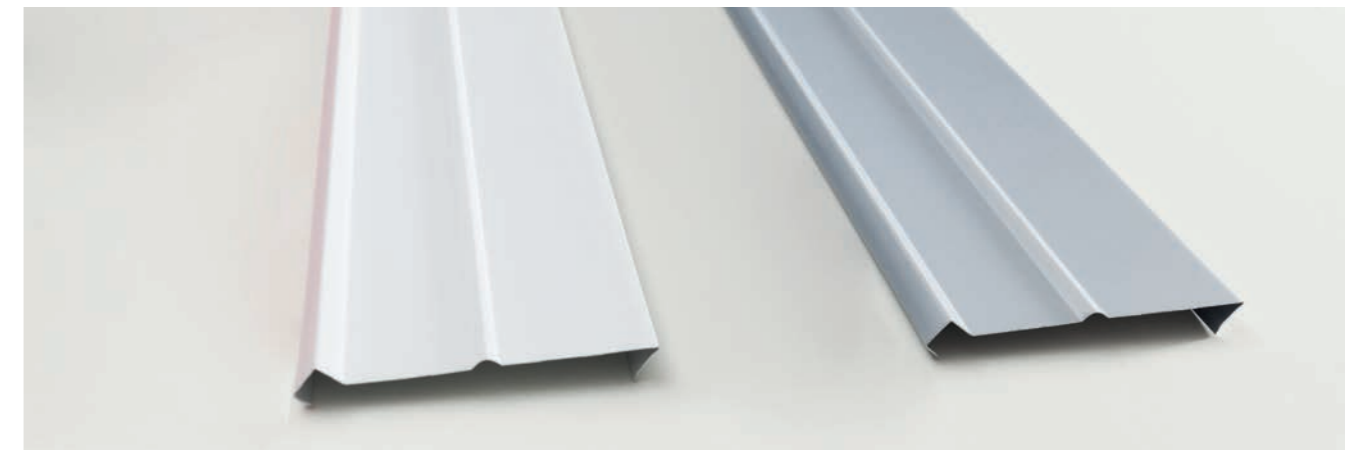

Staves manufactured from pre-lacquered aluminium of 0.45 mm thickness, plus coatings formed by cold rolling. Staves pre-lacquered in polyester with a thickness of 20 micrometres on both sides in colour White or Silver THU 9006. This type of finish is highly resistant to corrosion and offers excellent durability (gloss and colour retention).

verona stave

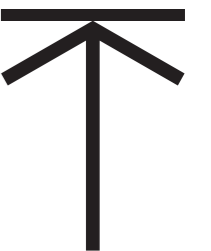

mounting

The Verona staves are clipped into U-shaped battens with prongs every 50 mm, being able to leave gaps between staves in multiples of 50 mm. These battens have holes on their top side, which house threaded rods that are used to suspend the system from the upper framework.

*For more information, please see the mounting manual.



Technical File



Mounting Manual

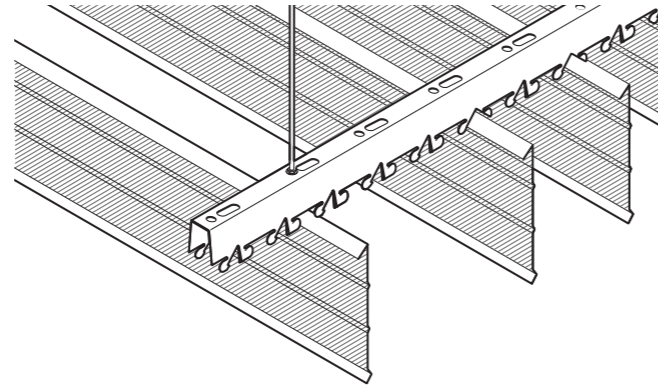

accessories

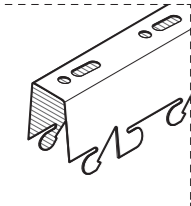

Batten

Element for the lengthwise attachment of the Verona staves, lacquered in black, which is suspended from the framework via threaded rods housed in the upper part.

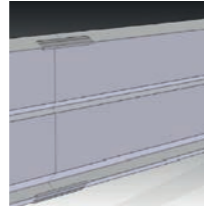

Stave splice part

Clear plastic element shaped like a peg, designed to align the staves along the lengthwise splices.



Light

Linear light fitting specially designed to be installed and built into this ceiling model.

Manufactured as per the lengths and technical requirements of the project: light flow, colour temperature, regulation, etc. Very easy to install and does not require accessory structures to place it.

technical details

Verona 100

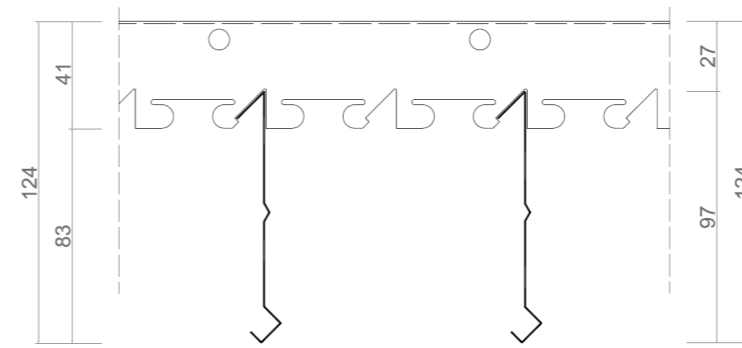

Verona 150

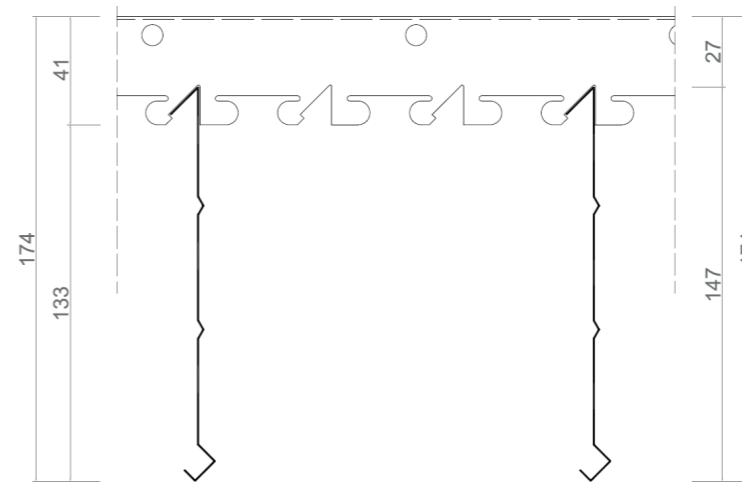

Verona 200

